

EXHIBIT D

SHEET 1 OF 1 SHEET

**ANNEXATION MAP NO. 47**  
**COMMUNITY FACILITIES DISTRICT NO. 2019-1**  
**(MAINTENANCE SERVICES)**  
**CITY OF SAN BERNARDINO**  
**COUNTY OF SAN BERNARDINO, STATE OF CALIFORNIA**

THIS MAP SHOWS THE BOUNDARIES OF AREAS TO BE ANNEXED TO COMMUNITY FACILITIES DISTRICT NO. 2019-1 (MAINTENANCE SERVICES), OF THE CITY OF SAN BERNARDINO, COUNTY OF SAN BERNARDINO, STATE OF CALIFORNIA.

THE BOUNDARIES OF WHICH COMMUNITY FACILITIES DISTRICT ARE SHOWN AND DESCRIBED ON THE MAP THEREOF WHICH WAS PREVIOUSLY RECORDED ON JUNE 6, 2019 IN BOOK 88 OF MAPS OF ASSESSMENT AND COMMUNITY FACILITIES DISTRICT AT PAGE 32 AND AS INSTRUMENT NO. 2019-0185323 IN THE OFFICE OF THE COUNTY RECORDER OF THE COUNTY OF SAN BERNARDINO, STATE OF CALIFORNIA.

I HEREBY CERTIFY THAT THE WITHIN MAP SHOWING PROPOSED BOUNDARIES OF COMMUNITY FACILITIES DISTRICT 2019-1 (MAINTENANCE SERVICES) FOR THE CITY OF SAN BERNARDINO, COUNTY OF SAN BERNARDINO, STATE OF CALIFORNIA, WAS APPROVED BY THE CITY COUNCIL OF THE CITY OF SAN BERNARDINO AT A REGULAR MEETING THEREOF, HELD ON THE \_\_\_\_ DAY OF \_\_\_\_\_, 20 \_\_\_\_.  
BY ITS RESOLUTION NO. \_\_\_\_\_

CITY CLERK, CITY OF SAN BERNARDINO

FILED IN THE OFFICE OF THE CITY CLERK THIS \_\_\_\_ DAY OF \_\_\_\_\_, 20 \_\_\_\_.

CITY CLERK, CITY OF SAN BERNARDINO

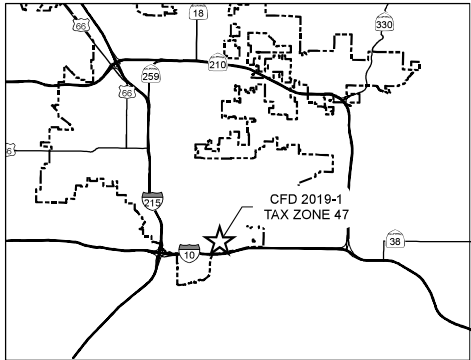

**SPICER**  
CONSULTING GROUP

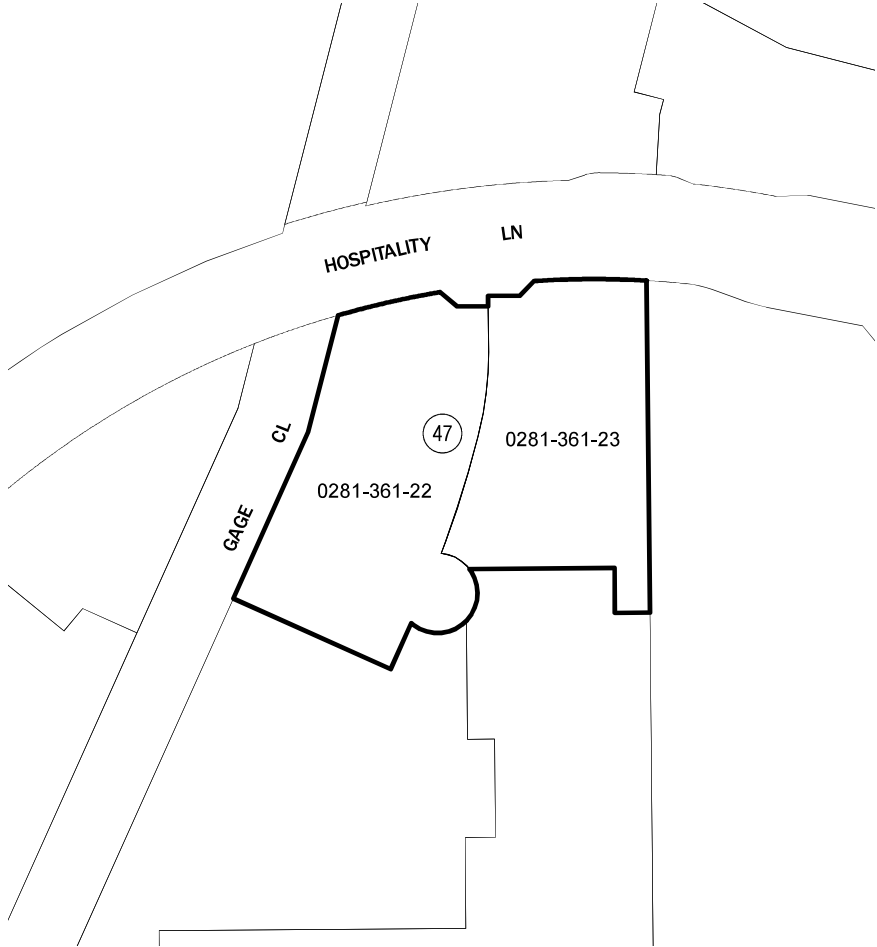

**SAN BERNARDINO COUNTY RECORDER'S CERTIFICATE**

THIS MAP WAS FILED UNDER DOCUMENT NUMBER \_\_\_\_\_, THIS \_\_\_\_ DAY OF \_\_\_\_\_, 20 \_\_\_\_,  
AT \_\_\_\_ M. IN BOOK \_\_\_\_ OF \_\_\_\_\_ AT PAGE \_\_\_\_,  
AT THE REQUEST OF CITY OF SAN BERNARDINO IN THE AMOUNT  
OF \$ \_\_\_\_\_.

CHRIS WILHITE  
ASSESSOR-RECORDER  
SAN BERNARDINO COUNTY

BY: \_\_\_\_\_  
DEPUTY RECORDER

**LEGEND**

- ANNEXATION AREA BOUNDARY
- PARCEL LINE
- CITY BOUNDARY
- XXXX-XXX-XX ASSESSOR PARCEL NUMBER
- 47 TAX ZONE

THIS ANNEXATION MAP CORRECTLY SHOWS THE LOT OR PARCEL OF LAND INCLUDED WITHIN THE BOUNDARIES OF THE COMMUNITY FACILITIES DISTRICT. FOR DETAILS CONCERNING THE LINES AND DIMENSIONS OF LOTS OR PARCEL REFER TO THE COUNTY ASSESSOR MAPS FOR FISCAL YEAR 2024-25.